

SABRE AIRCRAFT TOOLS

Angle Drill Collets Type A

9/32-40 Split Collets

Part No.	Hole Size	Part No.	Hole Size
SA910312	1/32	SA911024	2.6mm
SA910315	0.8mm	SA911040	37
SA910354	0.9mm	SA911063	2.7mm
SA910394	1.0	SA911065	36
SA910400	60	SA911094	7/64
SA910410	59	SA911102	2.8mm
SA910420	58	SA911142	2.9mm
SA910430	57	SA911181	3.0mm
SA910433	1.1mm	SA911220	3.1mm
SA910465	56	SA911250	1/8
SA910469	3/64	SA911260	3.2mm
SA910472	1.2mm	SA911285	30
SA910512	1.3mm	SA911299	3.3mm
SA910520	55	SA911339	3.4mm
SA910550	54	SA911378	3.5mm
SA910551	1.4mm	SA911406	9/64
SA910591	1.5mm	SA911417	3.6mm
SA910595	53	SA911440	#27
SA910625	1/16	SA911457	3.7mm
SA910630	1.6mm	SA911470	26
SA910635	52	SA911496	3.8mm
SA910669	1.7mm	SA911520	24
SA910670	51	SA911535	3.9mm
SA910700	50	SA911562	5/32
SA910709	1.8mm	SA911575	4.0mm
SA910730	49	SA911590	21
SA910748	1.9mm	SA911610	20
SA910760	48	SA911614	4.1mm
SA910781	5/64	SA911654	4.2mm
SA910785	47	SA911660	19
SA910787	2	SA911693	4.3mm
SA910810	46	SA911719	11/64
SA910820	45	SA911730	#17
SA910827	2.1mm	SA911732	4.4mm
SA910860	44	SA911772	4.5mm
SA910866	2.2mm	SA911800	15
SA910890	43	SA911811	4.6mm
SA910906	2.3mm	SA911820	14
SA910935	42	SA911850	4.7mm
SA910938	3/32	SA911875	3/16
SA910945	2.4mm	SA911890	4.8mm
SA910960	41	SA911910	11
SA910980	40	SA911929	4.9mm
SA910984	2.5mm	SA911935	10
SA910995	19	SA911960	9
SA911015	38	SA911969	5.0mm

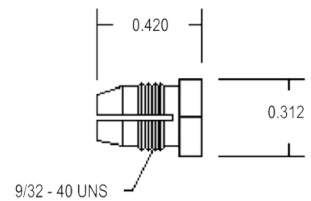

Other sizes available upon request

Add **(B)** to end of part number for Dotco-Buckeye Style
e.g.: SA910980B = #40 Collet



#SA21005

Adapter 9/32"-40 to 1/4"-28 Female

#SA21006

0.430" (11mm) Adapter 1/4"-28 to 9/32"-40 Female

Safety Precaution: Read and follow all safety and operating instructions.

WARNING: Face and eye protections must be worn while operating power tools, per ANSI B186.1

Products and specifications subject to change without prior notice.



www.sabretools.com
info@sabretools.com